

MESA CON ESTRUCTURA METÁLICA (M160)

VISTA SUPERIOR
ESTRUCTURA TUBO RECTANGULAR 60X30

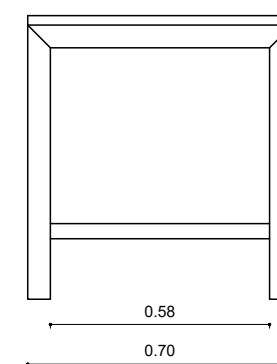

TAPA MELAMINA 25 MM

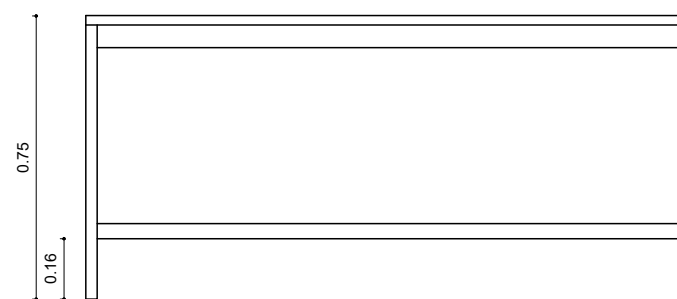
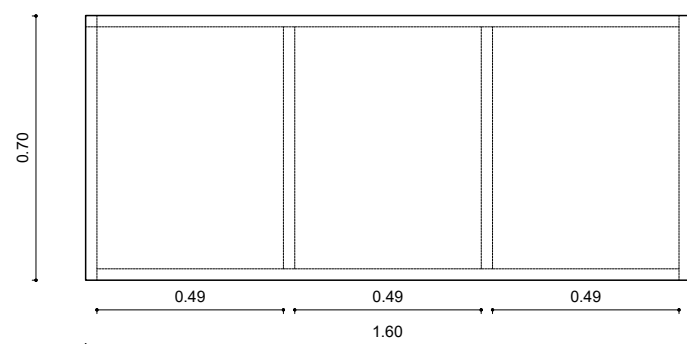
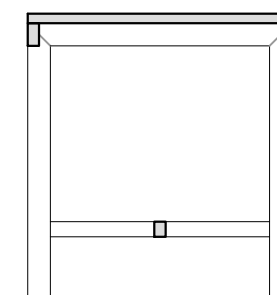
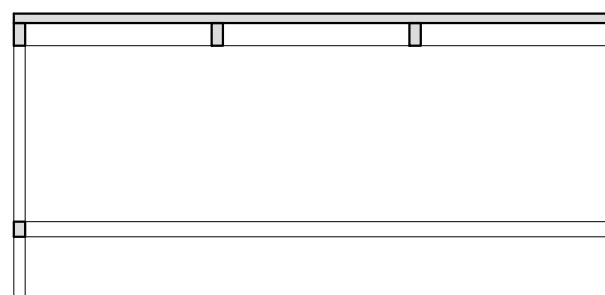

MESA CON ESTRUCTURA METÁLICA (M170)

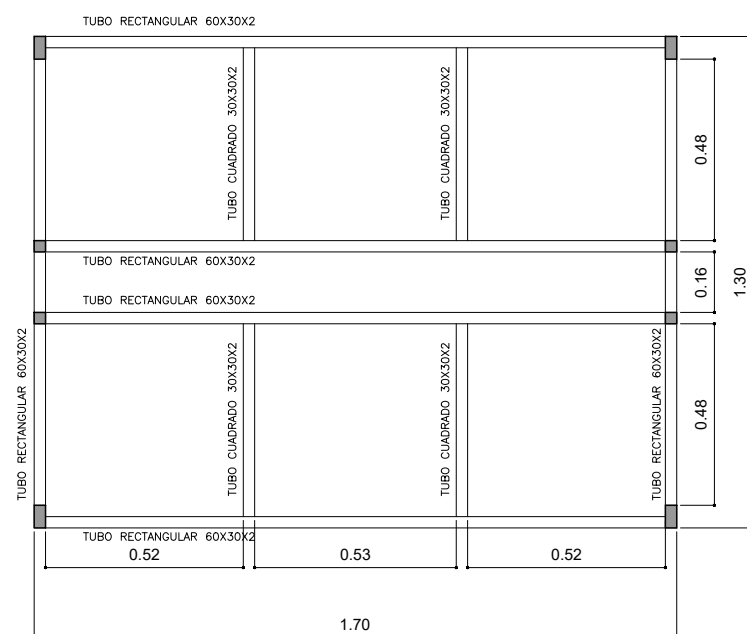

ESTRUCTURA

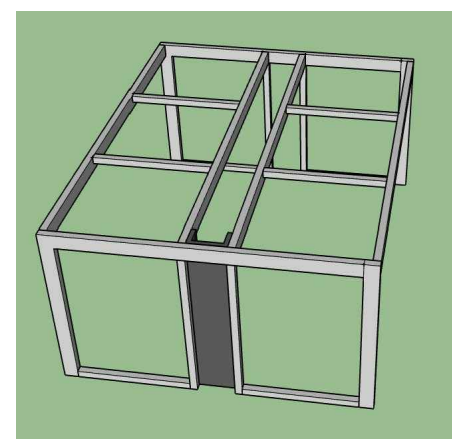
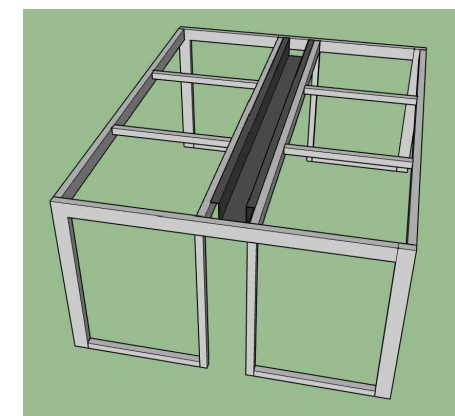
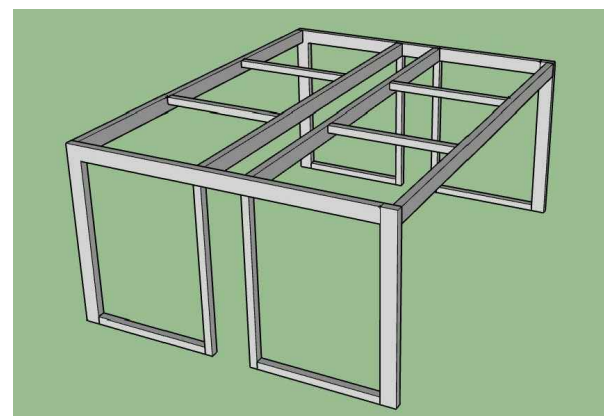

PODER JUDICIAL
DE LA PROVINCIA
DE SANTA FE

OFICINA DE ARQUITECTURA
DEL PODER JUDICIAL DE SANTA FE

OBRA:
MOBILIARIO PARA
TRIBUNALES DE
SAN CRISTÓBAL

PLANO N°:

M-06